

**Ford 6.2L: G, 2011+, A Pump, Side Port, High Pressure**

**BOLT PACKAGES:**

BRACKET	716053 (Inc. item 4, 8, 11-19)
IDLER PULLEY	None
CRANK PULLEY	None
TENSIONER	None
FAN SPACER	None

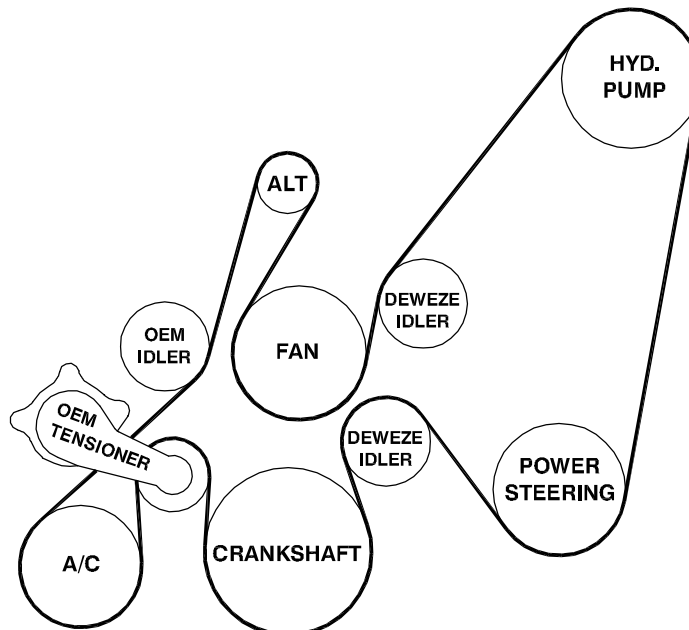
12-3-10 ISSUE DATE : A 2-14-11 REVISION DATE

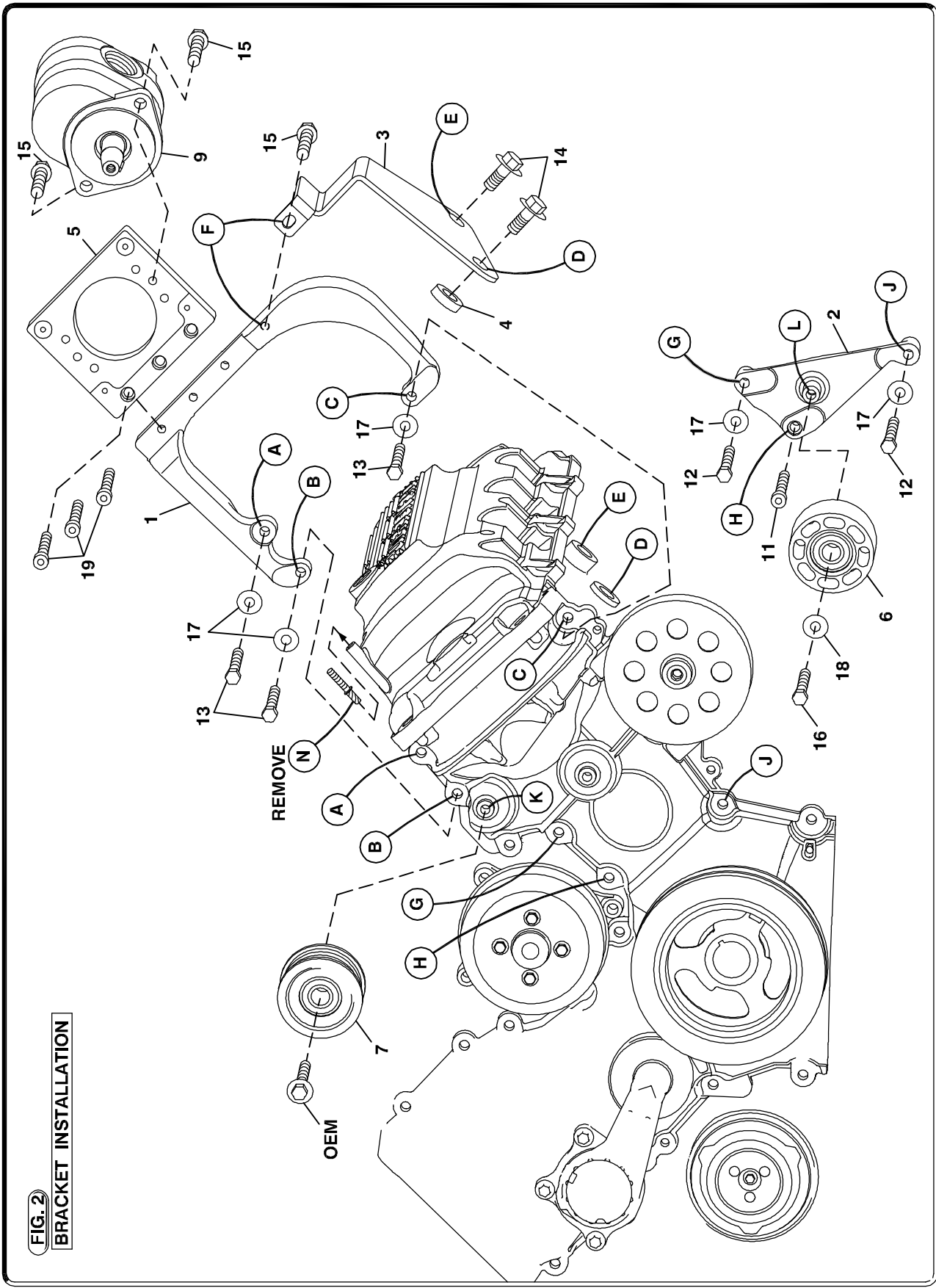
**Item | Quan. | Part No. | Description**

1.	1	716047	PUMP MOUNT BRACKET	23.	1	702111	AIR TUBE
2.	1	716048	IDLER BRACKET	24.	1	702112	REDUCER, AIR INTAKE
3.	1	716049	BRACE, PUMP MOUNT	25.	1	702113	ELBOW, AIRBOX
4.	1	716050	BUSHING, BRACE	26.	3	702114	CLAMP, 3.5"
5.	1	711906	PUMP PLATE	27.	1	702115	CLAMP, 4"
6.	1	740151	IDLER, FLAT	28.	1	120088	HOSE SPLICE
7.	1	740427	IDLER, 6-GROOVE	29.	1	716052	HOSE, 1.5" ID X 2.25" LONG
8.	1	110662	WASHER, 1/2 FLAT	30.	2	511002	CLAMP, HOSE #24 1.5"
9.	1	*	PUMP	31.	5	100578	CABLE TIE, 14"
10.	1	742016	CLUTCH, 6 GROOVE w/DIODE	32.	1	740283	BELT
11.	1	110775	BOLT, M8 X 1.25 X 60 LOWHEAD SOCKET				
12.	2	110569	BOLT, M8 X 1.25 X 65 HEX HEAD				
13.	3	110558	BOLT, M8 X 1.25 X 50 HEX HEAD				
14.	2	110933	BOLT, M16 X 2.0 X 35 FLANGE HEAD				
15.	3	110440	BOLT, 3/8-16 X 1 FLANGE HEAD				
16.	1	110435	BOLT, 3/8-16 X 1.5 HEX HEAD				
17.	5	110703	WASHER, M8 FLAT				
18.	1	110676	WASHER, 3/8 FLAT				
19.	3	110465	BOLT, 3/8-16 X 1.25 SOCKET HEAD				
20.	--	-----	-----				
21.	--	-----	-----				
22.	--	-----	-----				

**FIG. 1**

**BELT DIAGRAM**

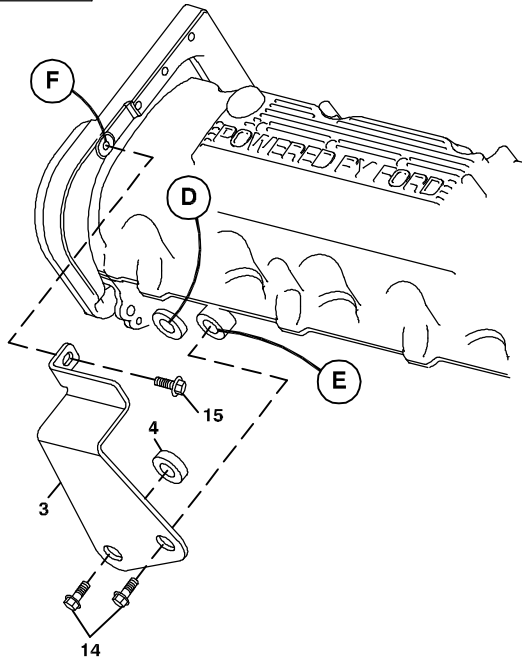




**FIG. 2**  
**BRACKET INSTALLATION**

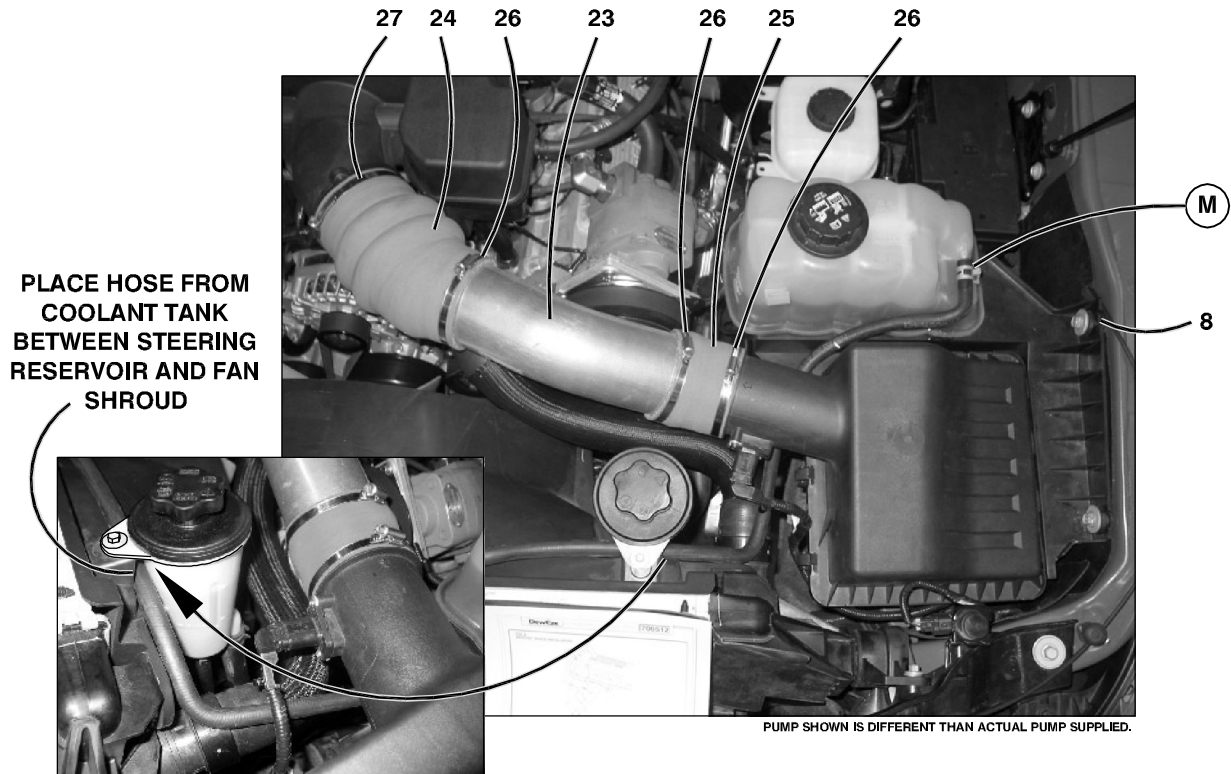
**FIG. 3**

**BRACKET BRACE INSTALLATION**



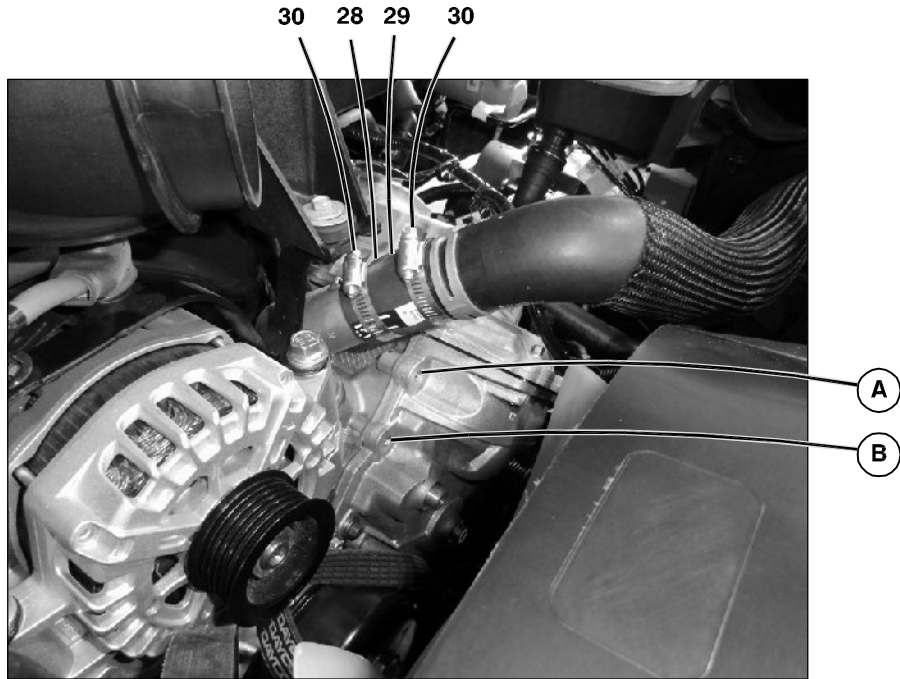
**FIG. 4**

**AIR TUBE REPLACEMENT**



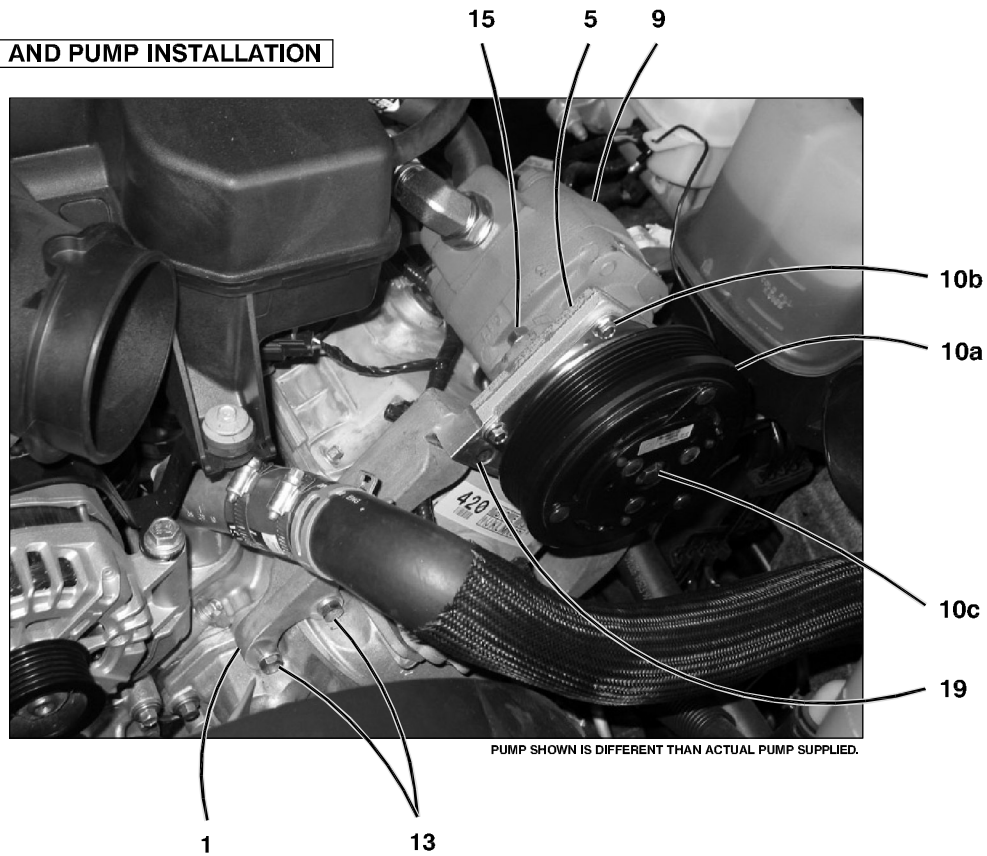
**FIG. 5**

**BRACKET LOCATION  
RADIATOR HOSE SPLICE**



**FIG. 6**

**BRACKET AND PUMP INSTALLATION**



# DewEze Clutch Pump Kit 700520

Ford 6.2L Gas, A Pump, Side Port, Hi Pressure, 2011+

## INSTALLATION INSTRUCTIONS

- The installation of this kit requires trained decision-making concerning clearances, tying components together, rerouting, or relocating OEM components, etc. It is impossible to describe all of the clearance and vibration points, etc. in the installation instructions. Therefore, the technician must exercise professional judgment to achieve the best quality installation.**
- Disconnect the battery.
- Remove the air tube connecting the air filter box to the intake box on top of the engine. Drain just enough of the engine coolant to remove the upper radiator hose from the engine water neck. Insert the hose splice (28) into the OEM radiator hose, push the short piece of radiator hose (29) onto the splice and onto engine with two 1.5" hose clamps (30). Unclamp the hose from the top front of the coolant tank (Location M), thread it between the power steering reservoir and the fan shroud and connect it back to the coolant tank. Replace coolant.
- The supply hose for the power steering pump must be rotated to clear the new belt routing. Hold the spring clamp with locking pliers, and rotate the hose as far towards the driver side fender as possible. Using a cable tie (31), secure the steering hose to the radiator hose running between the coolant tank and the radiator.
- Remove the rear bolt from the airbox attached to the fender and place the 1/2" heavy washer (8) between the airbox and the fender to angle the outlet tube forward. Reinstall the OEM bolt.
- Remove the three bolts on the lower portion of engine at Locations G, H, and J. Install the idler bracket (2) with two M8 x 65 hex head bolts (12) and two M8 flat washers (17) at Locations G and J. Insert the M8 x 60 low head socket head bolt (11) at Location H. Install the flat idler (6) with 3/8 x 1 1/2 bolt (16) and 3/8 flat washer (18) at Location L.
- Install the pump bracket brace (3) to the two large threaded holes on the side of the cylinder head at Locations D and E, placing the bushing (4) between the front hole and the bracket using M16 x 35 flange bolts (14). Do not completely tighten.
- Remove the OEM flat idler at Location K. Remove the OEM stud bolt holding the wiring clip at Location N. Let the wiring rest below the pump. Remove the three bolts at locations A, B, and C. Install the pump bracket (1) with three M8 x 50 hex bolts (13) and three M8 flat washers (17). Fasten brace to pump bracket with 3/8 x 3/4 flange head bolt (15) through brace into back of pump bracket. Tighten all the bolts on the brace. Install the 6-groove idler (7) at Location K with the OEM bolt.
- Mount the pump (9) to the back of the pump plate (5) with two 3/8 x 3/4 flange-head bolts (15). Install fittings to pump, then install pump plate with three 3/8 x 1.25 socket head bolts (19). Mount the clutch coil (10a) to the pump bracket with four 1/4 x 1/2 flange bolts (10b). Mount the clutch pulley (10c) to the pump shaft with the 5/16 x 1 1/4 bolt (10d) and heavy flat washer (10e) making sure the key is in place on the shaft.
- Install belt (32) according to diagram.
- Place elbow (25) onto airbox with 3.5" clamp (26). Insert DewEze air tube (23) into elbow using a 3.5" clamp (26). Place 3.5" end of reducer onto air tube using 3.5" clamp (26), also pushing 4" end onto air intake using the 4" clamp (27). Make sure there is clearance between the air tube and the clutch. Adjust the air tube and elbow by twisting them if needed.
- Reconnect the battery.
- Run the engine and check for any clearance or alignment problems. Adjust as needed.