

Bracket Assy.	711475	(Inc. items 1-3, 27)
Bolt Packages:		
Bracket	711476	(Inc. items 9-12, 15, 17, 18, 24)
Pulley	None	
Idler	711477	(Inc. items 4, 8, 20, 22, 23)
Tensioner	None	

Make	Chevy C6500, C7500
Engine	Cat 3126
Fuel	Diesel
Year	2003-
Equipment	Turbo, A/C
Revised	NC 12-12-02

Item	Part No.	Description
1.	711470	Pump bracket
2.	711472	Idler bracket
3.	711473	Filter bracket
4.	711474	Idler bushing
5.	740261	Idler pulley
6.	*	Pump, rear port
7.	740148	Clutch
8.	110219	7/16-14 Lock nut
9.	110526	M10 x 40 x 1.5 Bolt
10.	110558	M8 x 50 x 1.25 Bolt
11.	110225	M12 x 90 x 1.75 Bolt
12.	110479	M10 x 30 x 1.5 Bolt
13.	110425	3/8-16 x 1 1/4 Bolt
14.	OEM	Bolt
15.	110421	5/16-18 x 1 1/4 Bolt
16.	OEM	M12 Nut
17.	110703	M8 Flat washer
18.	110689	M10 Lock washer
19.	OEM	Fuel filter
20.	110719	7/16-14 x 3 Carriage bolt
21.	110676	3/8 Flat washer
22.	110702	7/16-14 x 2.25 Bolt
23.	110670	7/16 Flat washer
24.	110603	5/16-18 Lock nut
25.	700259	Hose, fuel filter 26"
26.	700260	Hose, fuel filter 15"
27.	711471	Bracket spacer
28.	740279	Belt, Micro-V K071134

FIG. 1

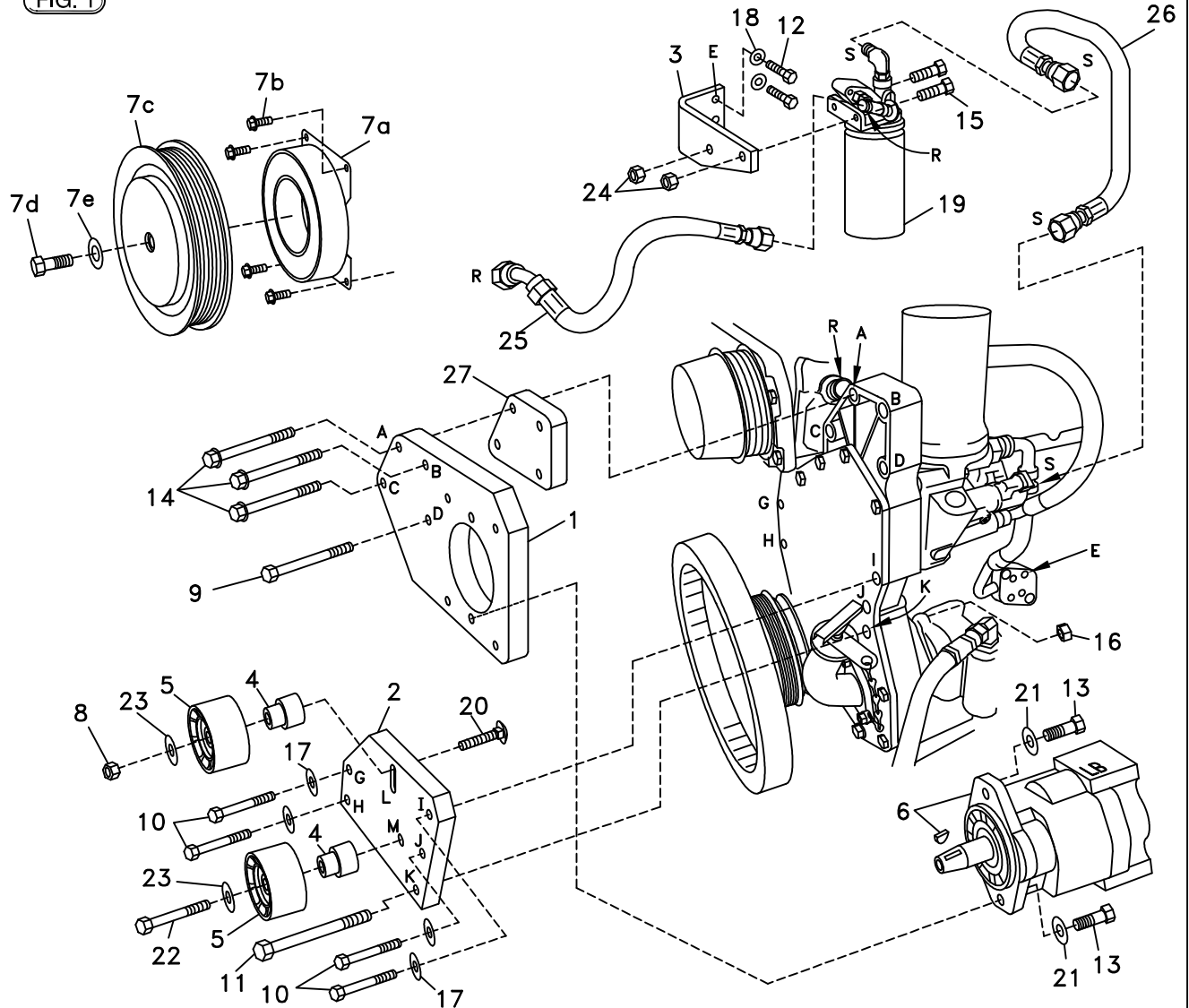

A, B, C... Denotes bolt holes in engine to locate corresponding holes in Pump Brkt.

FIG. 2

OEM CONFIGURATION

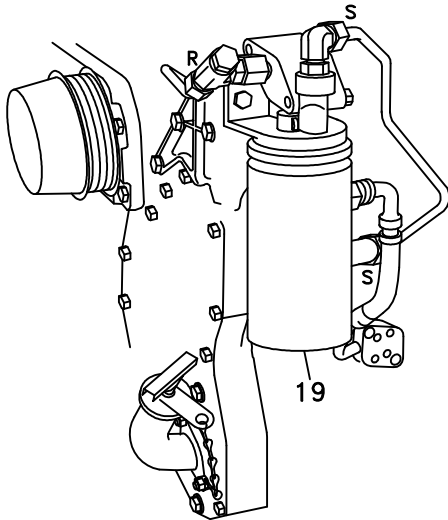
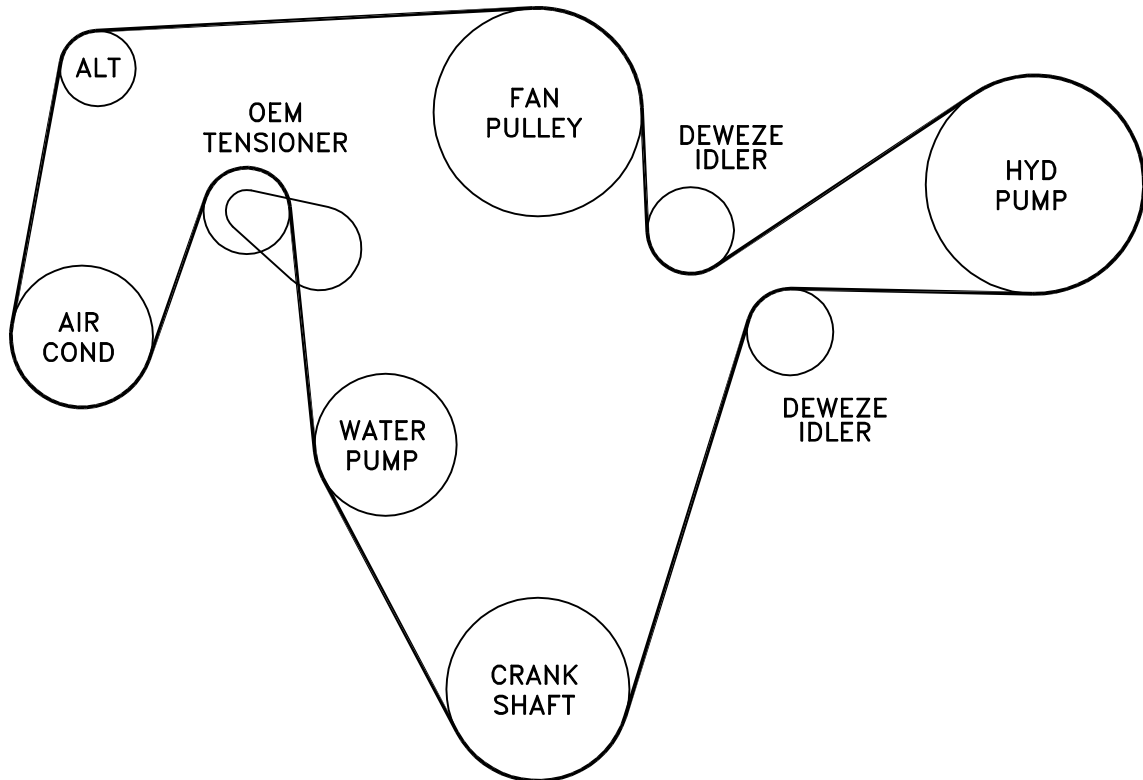

FIG. 3

BELT DIAGRAM



DewEze

Clutch Pump Kit

Clutch Pump Kit
700407
Chevy C6500
Chevy C7500
with Cat 3126
2003-

INSTALLATION INSTRUCTIONS

1. Disconnect the battery.
2. Remove the inner fenders.
3. Remove the driver's side intercooler tube. Remove the OEM belt.
4. Disconnect the two fuel lines (Locations R and S) from the fuel filter (19) and the engine. Be sure not to lose the o-rings on the fittings when removing the lines. Remove the two bolts mounting the filter, and then remove the filter.
5. Remove the OEM bolts from Locations A through D and G through J. Remove the OEM bolt and nut from Location K. Save the bolts from A, B, and C and the nut from K to use again. Remove the OEM filter mounting bracket from the engine.
6. Mount the filter mounting bracket (3) to the engine at Location E with the two M10 x 30 bolts (12) and two M10 lock washers (18). Connect the 45° end of the long hose (25) to the engine at Location R. Connect the other end to the filter at Location R. Connect the short hose (26) to the engine at Location S and to the filter at Location S. Attach the filter to the bracket with the two 5/16 x 1 1/4 bolts (15) and 5/16 lock nuts (24). Tighten all fittings on the filter and engine.
7. Place the 7/16 carriage bolt (20) in the slot in the back of the idler plate (2). Attach the idler plate to the engine with four M8 x 50 bolts (10) and four M8 flat washers (17) at Locations G, H, I, and J. Thread the M12 x 90 bolt (11) into Location K using the OEM M12 nut on the back.
8. Push one idler bushing (4) into one idler (5) and the other idler bushing into the other idler. Mount one idler to the idler bracket (2) with the 7/16 x 2 1/4 bolt (22) and 7/16 flat washer (23). Place the other idler and bushing on the carriage bolt, holding it on with the 7/16 nut (8) and 7/16 flat washer (23). Snug the nut down just enough to hold the idler at the top of the slot.
9. Mount the pump (6) to the pump plate (1) using 3/8 x 1 1/4 bolts (13) with 3/8 flat washers (21). Mount the clutch coil (7a) to the pump bracket with four 1/4 x 1/2 flange bolts (7b). Install the hose fittings on the pump. Place the pump bracket (1) with the spacer plate (27) on the rear of the plate onto the engine using the OEM bolts (14) at Locations A, B, and C. Thread the M10 x 40 bolt (9) into Locations D.
10. Mount the clutch pulley (7c) to the pump shaft with the 5/16 x 1 1/4 bolt (7d) and heavy flat washer (7e) making sure the key is in place on the shaft.
11. Install the belt (28) as shown in the diagram (Fig. 3) placing it on the rear seven grooves of the clutch pulley, leaving the one front groove open. Hold the tensioner down as far as it will go and place the belt on all the pulleys. Push the top idler down and tighten the nut. This is to take the slack out of the tensioner.
12. Replace the intercooler tube. Reconnect the battery.
13. Run the engine and check for any fuel leaks or clearance or alignment problems. Adjust as needed.