

None	Bracket Assy.	Kit No.	700398
711429	Bracket Bolt Pkg. (Inc. items 11, 12, 14, 17, 21-23, 30-32)	Make	Mitsubishi FG
711388	Pulley Bolt Pkg. (Inc. item 28, 22, 23)	Engine	3.9L
711389	Idler Bolt Pkg. (Inc. item 13)	Fuel	Diesel
740329	Tensioner Assy. (Inc. items 6, 7, 15, 16)	Year	2002-
		Equipment	Turbo, A/C
		Revised	A 3-11-03

ITEM	PART #	DESCRIPTION			
1.	711386	Engine bracket	17.	110351	3/8-16 x 1 1/4 Gr. 8 Bolt
2.	711428	Pump plate	18.	110425	3/8-16 x 1 1/4 Bolt
3.	711430	Filler plate	19.	110676	3/8 Flat washer
4.	740354	Crank pulley	20.	OEM	Spacer
5.	740350	Idler pulley/flat	21.	711391	M8 x 120 x 1.25 Tap bolt
6.	740289	Tensioner	22.	110674	5/16 Lock washer
7.	740233	Idler pulley/6-groove	23.	110665	5/16 Flat washer
8.	*	Pump/rear port	24.	OEM	Hub/idler
9.	740144	Clutch	25.	OEM	Nut/tensioner
10.	OEM	Idler pulley/AC	26.	OEM	Nut/fan
11.	110479	M10 x 30 x 1.5 Bolt	27.	OEM	Belt/Air cond.
12.	110526	M10 x 40 x 1.5 Bolt	28.	110291	M8 x 60 x 1.25 Gr 10.9 Bolt
13.	110253	7/16-14 x 1.18 Flange hd bolt	29.	OEM	Fan
14.	110250	3/8-16 x 2 1/2 Skt head bolt	30.	110264	10-24 x 1/2 Screw
*15.	110248	7/16-14 x 1 3/8 LH Bolt	31.	110631	10-24 Lock nut, nylon
	110707	M10 x 25 x 1.5 LH Bolt	32.	110672	3/8 Lock washer
16.	110252	Large cupped washer	33.	740362	Belt/Micro-V K060670

\*Either one of these bolts may be supplied with the tensioner.

FIG. 1  
BELT DIAGRAM

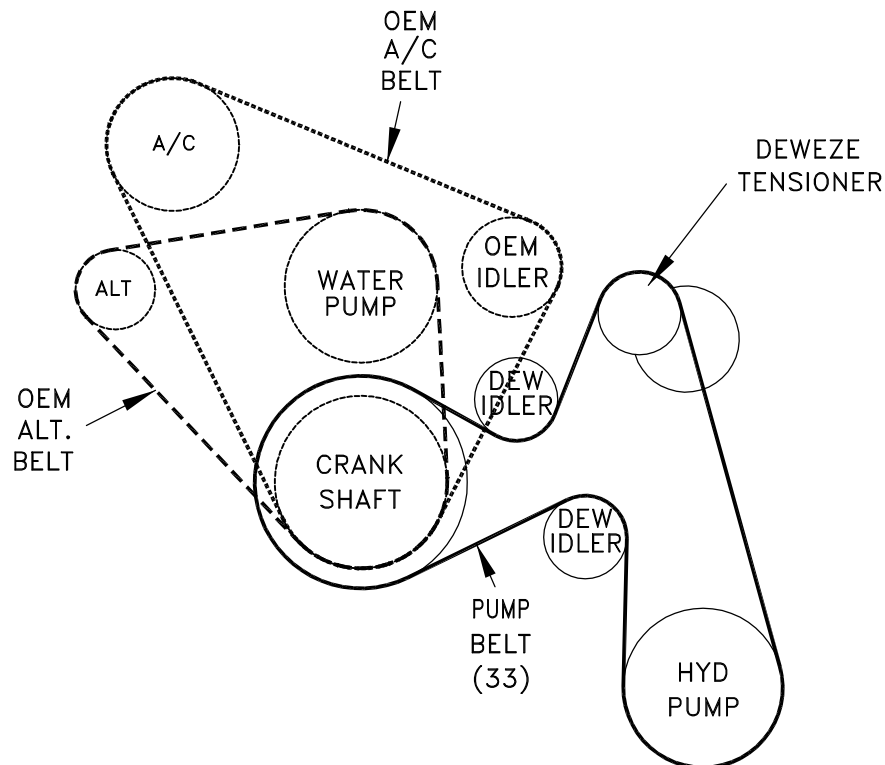

(A)(B)(C)... Denotes bolt holes in engine to locate corresponding holes in Pump Brkt.



FIG. 3

CUT FAN SHROUD AS SHOWN – BOTH OUTSIDE AND INSIDE WALLS

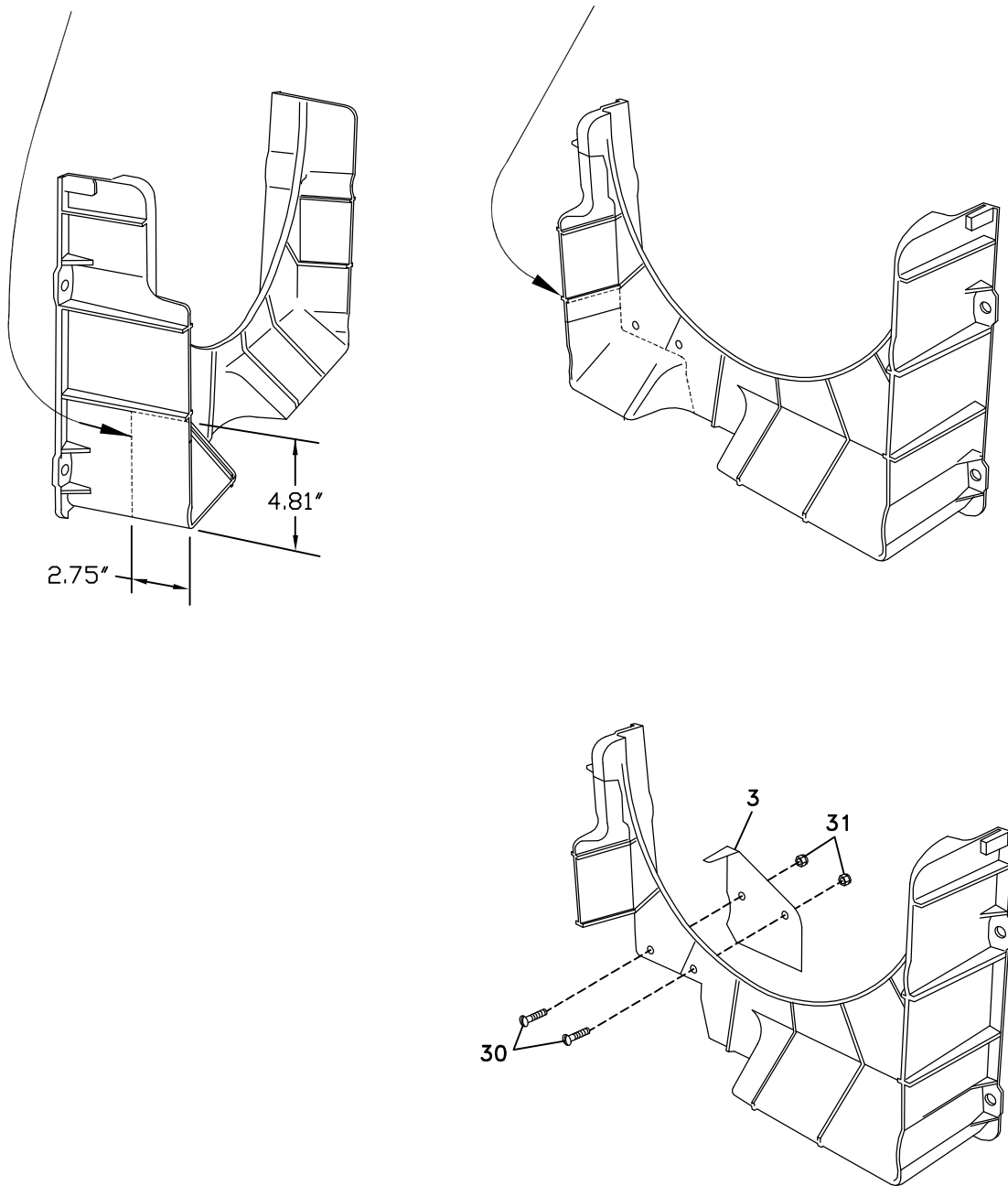

# DewEze

Clutch Pump Kit  
#700398  
Mitsubishi  
3.9 L  
Turbo diesel  
4 Whl Drv  
'A' mount  
2002-

## INSTALLATION INSTRUCTIONS

1. Disconnect the battery.
2. Drain enough coolant from the radiator to get the level below the top hose. Remove the hose.
3. Remove the OEM intercooler hose.
4. Remove the OEM top fan shroud. Unbolt the fan by loosening four nuts (26). Lift out the fan.
5. Remove the lower shroud from the radiator. Cut out the section from the shroud as shown in Fig. 3. Remove both the outer and inner walls. Hold the filler plate (3) inside the cutout in the front (the fan side) of the shroud. Mark the two hole locations in the plate onto the shroud. Drill holes with a 3/16" drill. Attach the plate to the inside of the shroud with the two 10-24 x 1/2 screws (30) and two 10-24 lock nuts (31). Mount the lower shroud back on the radiator.
6. Attach the crankshaft pulley (4) to the crankshaft damper with four M8 x 60 bolts (28), four 5/16 lock washers (22) and four 5/16 flat washers (23).
7. Loosen the OEM air conditioner tensioner adjusting bolt (21). Remove the air conditioner belt. Remove the OEM tensioner bracket from the engine. Disassemble the individual pieces from the tensioner.
8. Bolt the DewEze engine bracket (1) onto the engine at locations A and C with the M10 x 30 bolt (11). Thread the M10 x 45 (12) bolt into location B.
9. Reassemble the A/C tensioner parts in the engine bracket: Hold the idler hub (24) in the cavity in the rear, lining up the flat spots on the shoulder so they fit in the slot. Place the lock washer (22) and the flat washer (23) on the DewEze M8 x 120 adjusting bolt (21), insert through the hole in the edge of the bracket at location E, and thread into the idler hub. Place the spacer (20) on the front of the hub. Insert the nut (25) into the center of the idler (10) and thread onto the hub and tighten. Replace the OEM air conditioner belt and adjust.
10. Mount the two idlers (5) onto the bosses on the engine bracket using the two 7/16 x 1 3/16 flange head bolts (13).
11. Bolt the pump (8) to the back of the pump plate (2) with two 3/8 x 1 1/4 bolts (18) and two 3/8 flat washers (19).
12. Bolt the pump plate (2) to the engine bracket (1) with the three 3/8 x 1 bolts (17) and three 3/8 lock washers (32) at location D. Install the fittings on the rear of the pump so the hoses can be routed to them.
13. Mount the clutch coil (9a) to the front of the pump plate with the four 1/4 x 1/2 flange bolts positioning the wire to the outboard side. Mount the clutch pulley (9b) to the pump shaft with the 5/16 x 1 1/4 bolt and heavy flat washer.

14. Attach the idler pulley (7) onto the tensioner (6) with either the 7/16 x 1 3/8 left hand flange-head bolt or M10 x 25 left hand flange-head bolt (15, whichever one is supplied with the tensioner) and the large cupped washer (16). Install the tensioner on the engine bracket at location F with the 3/8 x 2 1/2 socket head bolt (14).
15. Install the pump drive belt (33).
16. Replace the fan using the OEM nuts (26). Replace the upper shroud. Put the coolant back in the radiator. Replace the OEM radiator hose.
17. Connect the battery.
18. Run the engine and check for any clearance or alignment problems. Adjust as needed.