

**DewEze****CLUTCH PUMP KIT**

710093	Bracket Assy. (Inc. items 1, 2, 3, 17)		Kit No.	700339
711201	Bracket Bolt Pkg. (Inc. items 4, 7, 8, 15, 18-20)		Make	Ford
None	Pulley Bolt Pkg.		Engine	7.3L
711203	Idler Bolt Pkg. (Inc. items 11, 16)		Fuel	Diesel
None	Fan Spacer Bolt Pkg.		Year	1992.5-1994
			Equipment	A/C, Turbo
			Revised	B 4-3-06

ITEM	PART #	DESCRIPTION			
1.	710955	Pump mount plate	11.	110676	3/8 Flat washer
2.	711198	Alternator bracket	12.	740266	Belt/Micro-V
3.	711199	Base plate	13.	711202	Idler bracket
4.	711200	Spacer .750" long	14.	740151	Idler pulley, 3.00" flat
5.	*	Pump	15.	110579	3/8NC x 6 Gr 8 bolt
6.	740144	Clutch	16.	110213	M10 x 1.50 Torx head shoulder bolt
7.	110183	M10 x 100 x 1.5 Bolt	17.	711259	Gusset
8.	110395	3/8NC x 1 Socket head bolt	18.	711260	Spacer .700"
9.	110425	3/8NC x 1 1/4 Bolt	19.	110433	3/8NC x 3/4 Bolt
10.	110672	3/8 Lock washer	20.	110487	M10 x 120 x 1.5 Bolt

\* See master list for pump part no.

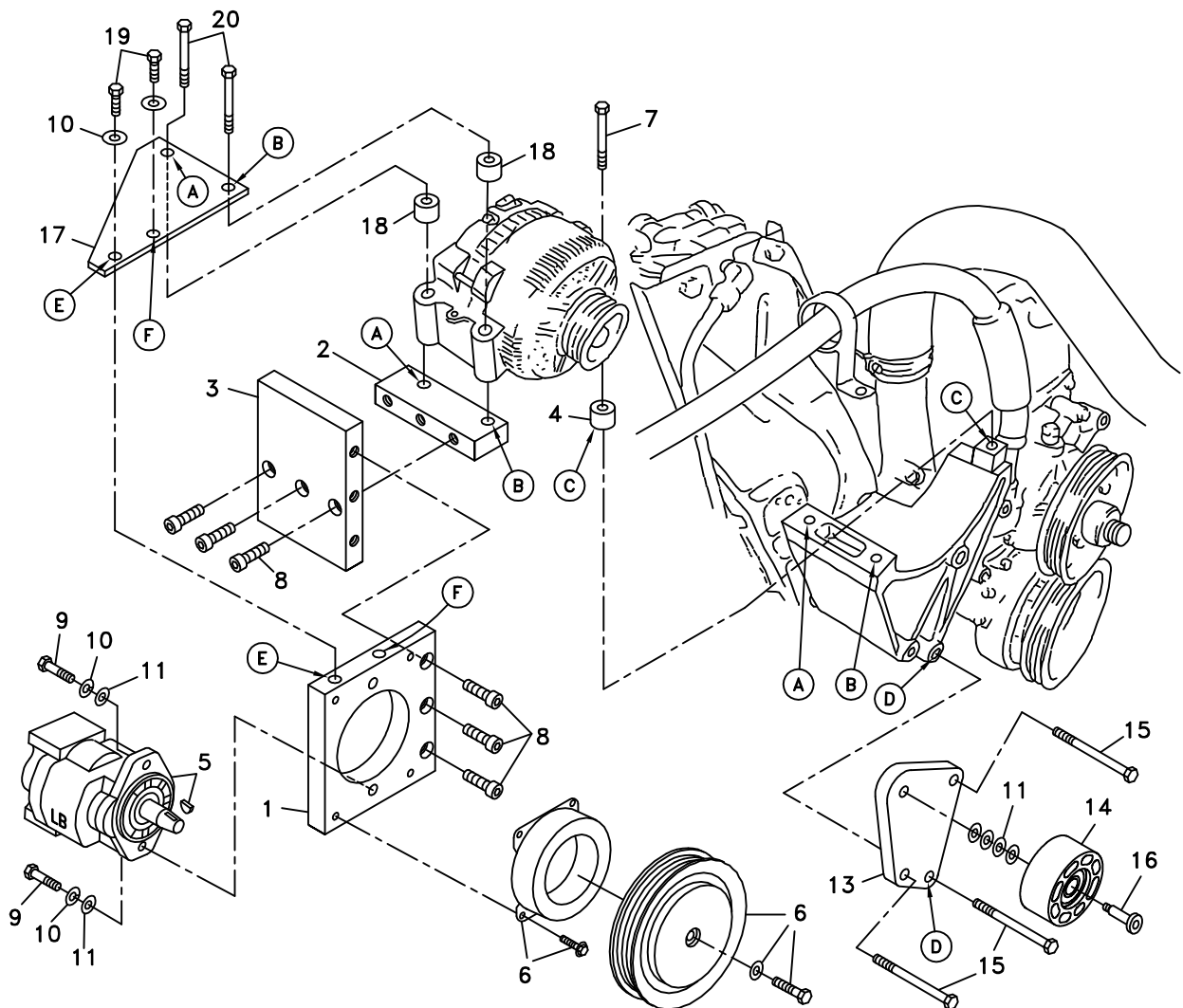

(A)(B)(C)... Denotes bolt holes in engine to locate corresponding holes in Pump Brkt.

FIG. 2

BELT DIAGRAM

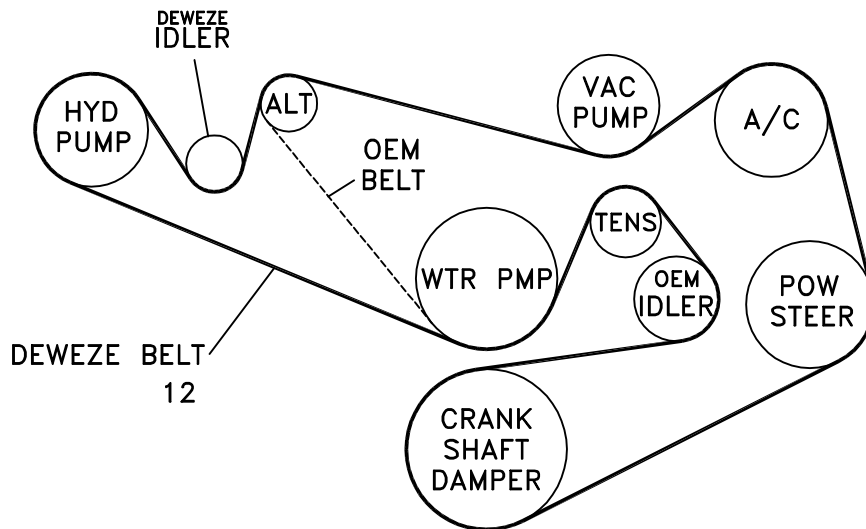

# DewEze

Clutch Pump Kit  
#700339  
Ford 7.3L  
With A/C  
1992.5-94

## INSTALLATION INSTRUCTIONS

**NOTE: Suction hose to pump must be a wire braid hose; minimum 1" I.D. for 7 & 9 gpm pumps; 1¼" I.D. for 12 & 17 gpm pumps. Installations with smaller suction hoses will void the pump warranty.**

1. Disconnect battery.
2. Remove OEM serpentine belt.
3. Remove three alternator mounting bolts. Lift the alternator up and place the alternator bracket (2) between alternator and OEM alternator mounting bracket on passenger side of alternator at locations A and B. Orient bracket as shown with the hole closest to the edge toward the front. Place the .700" long round spacer (4) between the alternator and OEM mounting bracket on driver's side at location C. Place the M10 x 100 bolt (7) through the alternator and the spacer and into the OEM mounting bracket at location C.
4. Mount the base plate (3) onto the alternator bracket (2) using three 3/8 x 1 socket head bolts (8). Orient the plate as shown with the countersunk holes to the outside or passenger side.
5. Attach the pump (5) to the back of the pump plate (1) using two 3/8 x 1¼ bolts (9), two 3/8 lock washers (10), and two 3/8 flat washers (11).
6. Mount the pump plate (1) with the pump to the base plate (3) with three 3/8 x 1 socket head bolts (8).
7. Place the two .750" long spacers (18) on top of the alternator at locations A and B. Lay the gusset (17) over the spacers and across the top of the pump plate. Insert two M10 x 120 bolts (20) through the gusset at locations A and B and into the alternator. Insert two 3/8 x 3/4 bolts (19) with two 3/8 lock washers (10) through the gusset at locations E and F and into the top of the pump plate. Tighten those four bolts.
8. Attach the clutch coil (6) to the front of the pump plate using the four flange bolts provided with the clutch. The front of the pump plate is identified by the three countersunk holes at the right of the plate. Attach the clutch pulley (6) to the pump shaft using the bolt and heavy flat washer provided with the clutch.
9. Insert the shoulder bolt (16) through the idler pulley (14) and place four 3/8 flat washers (11) on bolt. Thread bolt into tapped hole in idler bracket (13). Mount the idler bracket with idler to the front of the alternator mount at location D using three 3/8 x 6 grade 8 bolts (15).
10. Install the new serpentine belt (12) as shown in Fig. 2.
11. Connect the battery.
12. Run the engine and check for any clearance or alignment problems. Adjust as needed.